

*Decatur Public School District #61*

# MONTESSORI

## Program

*Garfield Montessori and Enterprise Montessori*



# 1: futures workshop

MONT

*students, teachers and parents*



## Montessori Program

# 1: futures workshop <sup>MONT</sup> *takeaways*

- Amphitheater
- Barn
- Bathroom Settings
- Cafeteria w/Flexible Seating and Spaces (outdoor option)
- Cafetorium/Food Court
- Campfire and Cave Space
- Care Room/Chill Space
- Closets and Cubbies
- Collaboration Space
- Family/Community Space
- Fitness Center/Yoga Room
- Flexible/Moveable Age Appropriate Storage
- Gardens
- Gathering Spaces
- Green Energy (windmills, etc.)
- Green House
- Group Learning Settings
- Large Hallways
- Larger care/room spaces w/ sensorial items
- Laundry/Food Prep
- Library/Collaboration Area
- Library/Resource Center - in classroom
- Maker Space
- Mud Room and Built in Shelving
- Observation Window
- Park/Pond
- Peace Areas
- Restorative Nursery
- Separate Rooms for Science/Arts
- Shelving, Organization Closets
- Sound-proofing Rooms
- Spaces That Induce a Desired Behavior
- Spatial Closet Area (variety of storage based on materials)
- Specialists
- Warm, Safe Area
- Wi-Fi Hubs
- Work Space



# 1: exemplar tour

MONT



Richland Community College:  
Carrol Center for Innovative Learning





Teacher Offices 2



Teacher Offices 4



Student Achievement

Core Student Learning Environments

Problem Based / Active Learning

Name of space	Flexible, open teacher/student friendly spaces
Taa	B8

"The Why"

Group #	B
Obstacle / Challenge	Levels of achievement
Possible Solution	Differentiation, flexible learning, combined grades
Learning setting	Flexible, open, teacher/student friendly

"The What"

Activities	differentiation - for flexible learning environments combined grades
------------	---

Areas

Flexibility Required	high
----------------------	------

Exploratory 10



# MONT

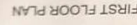

GARFIELD

SCALE 1/16" = 1'-0"



**BLDD**  
ARCHITECTS

DECATUR, IL | ILDO Project No. 186-EX 10.401 | 02.28.2019

# Cognitive Maps and Graffiti Maps with Students



- **Opportunities:** moving approx. 60,000 s.f. into 112,000 s.f.
- **Challenges:** Many areas of the building will remain untouched due to budget
- E2 & Middle School on 2nd Floor
- EC (east side, adjacent to parking lot) and E1 on the first floor
  - East access to drop off for EC strongly preferred
- Cafe / Bookstore / Library strongly supported
- No consensus on office location
- Preference for maintaining FACS space
- Desire to redevelop music "block"
- Develop outdoor learning environments
  - Courtyard
  - South fields
  - Rooftop garden

# 3: ideation

MONT

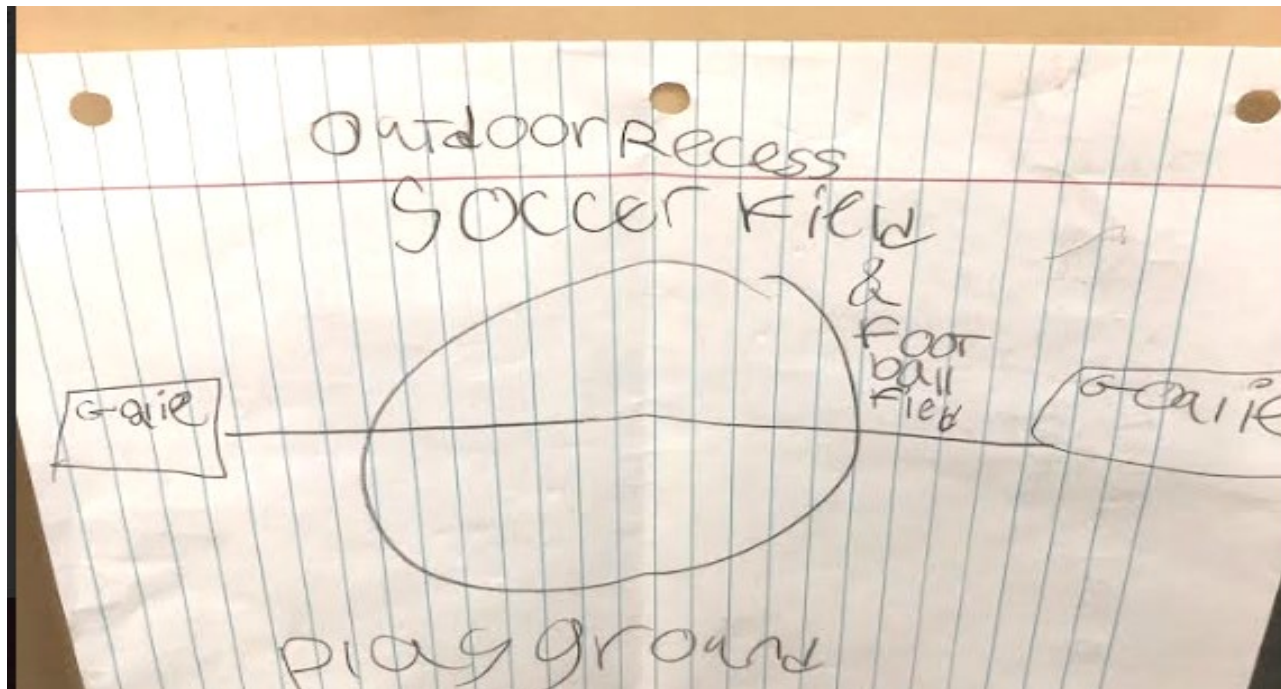



# 3: ideation

MONT



*Group Input and Feedback*



## 4: prototype MONT

**Montessori  
Program  
prototype will  
be presented  
via VR**





# NEXT STEPS

## *montessori program*

Design Development Presentation to BOE	6/11/19
Construction Docs Presentation to BOE	
Out for bids:	8/27/19
Accept bids:	10/8/19
Construction:	10/15/19 - 5/1/2020
Furnishing Installation:	6/1/19 - 7/1/20
School Move in:	7/1/20 - 8/1/20

**TOTAL REMODELING**

LIGHT: 28,486 SF  
MODERATE: 1,400 SF  
HEAVY: 16,789 SF  
CORRIDOR: 0 SF

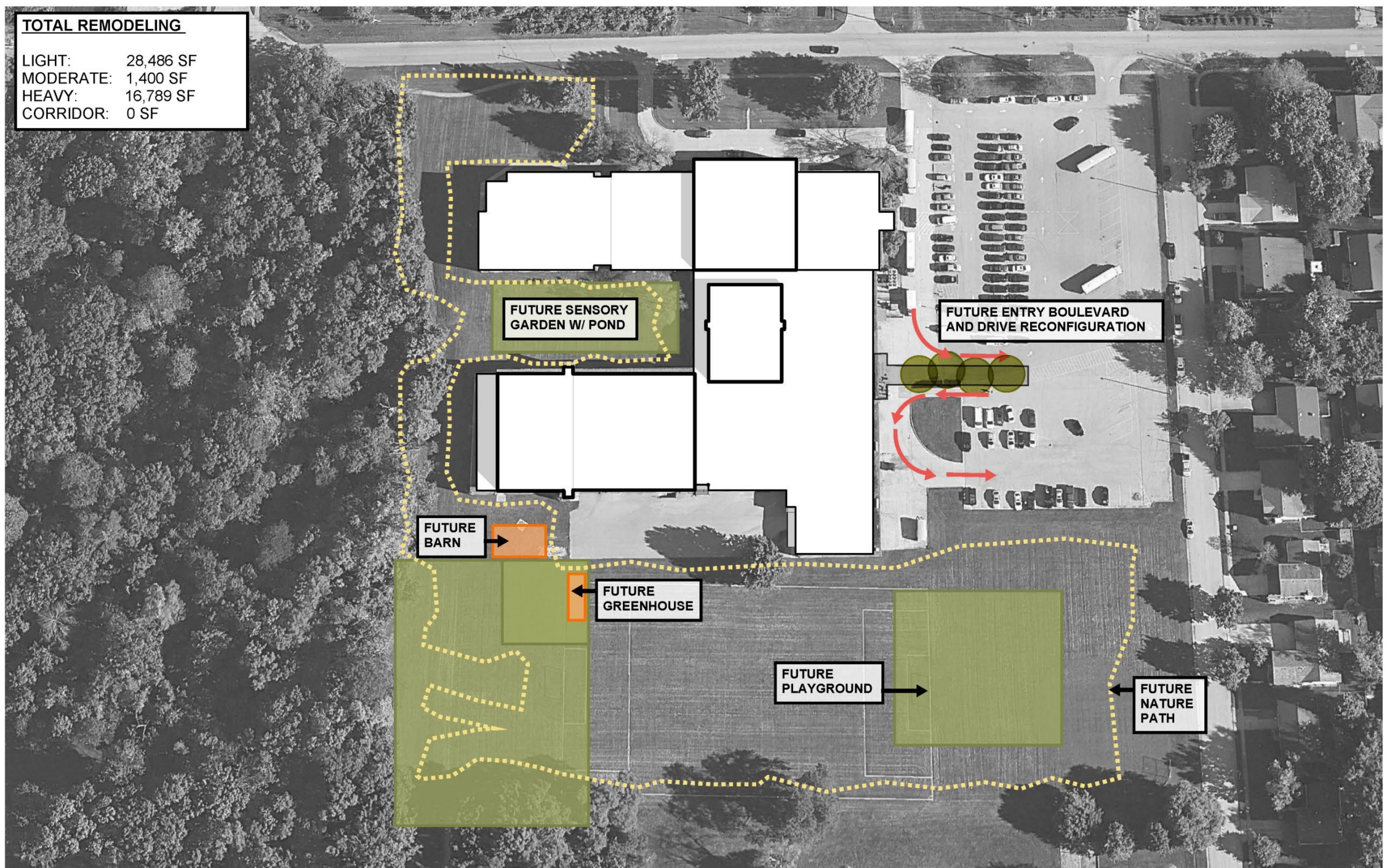

FUTURE SENSORY  
GARDEN W/ POND

FUTURE ENTRY BOULEVARD  
AND DRIVE RECONFIGURATION

FUTURE  
BARN

FUTURE  
GREENHOUSE

FUTURE  
PLAYGROUND

FUTURE  
NATURE  
PATH





MONTESSORI SCHOOL





$$\begin{aligned} \textcircled{1} \lim_{x \rightarrow 0} \frac{\sin(x)}{x} &= \frac{0}{0} \\ \lim_{x \rightarrow 0} \frac{\cos(x)}{1} &= \frac{\cos(0)}{1} \\ \lim_{x \rightarrow 0} \frac{e^x - 1}{x - 1} &= \frac{e^0 - 1}{0 - 1} = \frac{0}{-1} = 0 \\ \text{THE DR.} &= \frac{e^x}{x} = \frac{e^0}{0} = \frac{1}{0} = \infty \end{aligned}$$



















